



### 150W UFO AC LED HIGH BAY



#### Product Feature

- AC Integrated Driver, High Reliability, PF>0.98
- With OVP, OTP and OCP Protection
- 6KV Surge Protection(External SPD)
- LED SMD3030, CRI>80
- Can pass CE, RoHS,FCC,SAA,RCM Certification
- Close ring base, easy install
- CCT:3000K,4000K,6000K Options
- Long life:30,000 hrs,3 years warranty
- 60° beam angle (with lens)
- High efficiency, High Lumen LUX
- No UV or Infrared Radiation

#### Description

|                   |                                    |          |          |
|-------------------|------------------------------------|----------|----------|
| Light Source:     | SMD 3030 176pcs                    |          |          |
| Rated Power(W):   | 150W±5% @230VAC                    |          |          |
| Input Voltage(V): | 200-265VAC                         |          |          |
| PF:               | 0.98                               |          |          |
| Led Driver:       | AC linear                          |          |          |
| Surge Protection: | 6KV Surge Protection(External SPD) |          |          |
| Lumious(lm):      | 15000lm±5%                         |          |          |
| CCT(K):           | WW 3000K                           | NW 4000K | CW 6000K |
| CRI:              | >80                                |          |          |
| Beam Angle:       | 60°                                |          |          |
| Material:         | Aluminum +PC Diffusion Cover       |          |          |
| Lifespan(H)       | >30,000                            |          |          |
| Operation Temp.   | -33°C-55°C                         |          |          |
| Weight            | 1.6kg                              |          |          |
| Dimension(mm):    | Ø310*165mm                         |          |          |
| Packing:          | 365*365*263mm                      |          |          |

#### Product Application

Storage Lighting, Industrial Lighting, Architectural Lighting, Landscape Lighting, Store Lighting, Stadium Lighting



#### Dimension (mm)

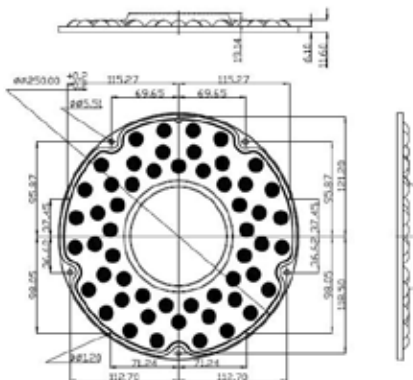

Lens

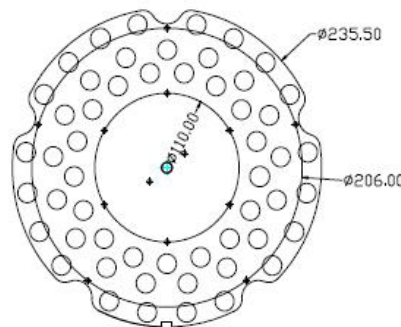

PCB

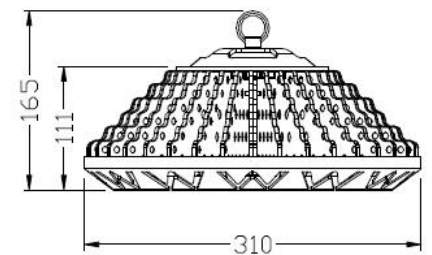

Heatsink

**PCB Light Board**

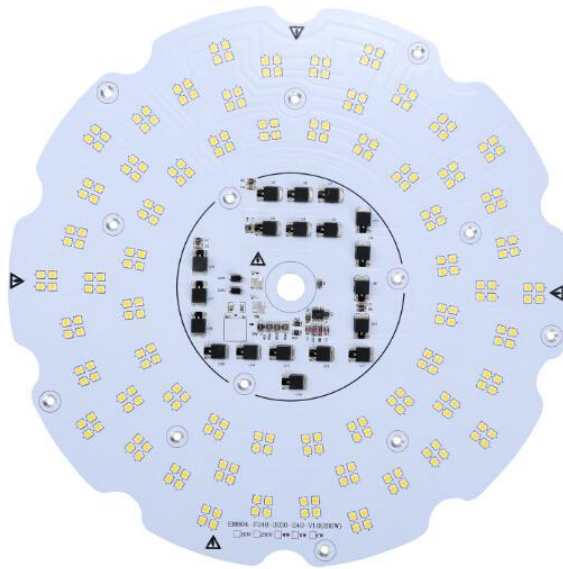

**60 Degree Lens Cover**



**Aluminum Heat Sink**



## Spectrum Test Report

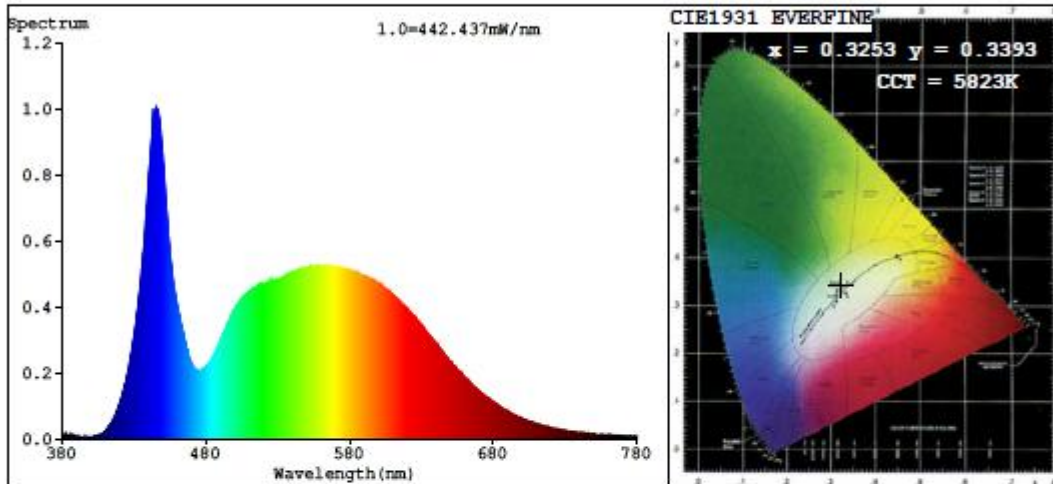

## Color Parameters:

Chromaticity Coordinate:  $x=0.3253$   $y=0.3393$   $u'=0.2027$   $v'=0.4756$

CCT=5823K(Duv=0.0024) Dominant WL:Ld =501.7nm Purity=2.4%

Ratio:R=14.4% G=80.8% B=4.9% Peak WL:Lp=445.6nm FWHM=21.4nm

Render Index:Ra=82.8

R1 =82 R2 =85 R3 =88 R4 =84 R5 =84 R6 =81 R7 =86

R8 =72 R9 =14 R10=66 R11=85 R12=67 R13=82 R14=93 R15=77

## Photo Parameters:

Flux = 14921 lm Eff. : 97.43 lm/W Fe = 48.35 W

## Electrical parameters:

V = 220.69 V I = 0.7040 A P = 153.2 W PF = 0.9858

WHITE:ANSI\_5700K

Status: Integral T = 10 ms Ip = 10760 (16%)

Model:  
Tester:Eson  
Temperature:25.3Deg  
Manufacturer:

Number:13  
Date:2016-06-21  
Humidity:65.0%  
Remarks:1

# 150W AC220V 5700K 60° Beam Angle (With lens)Distribution Test:

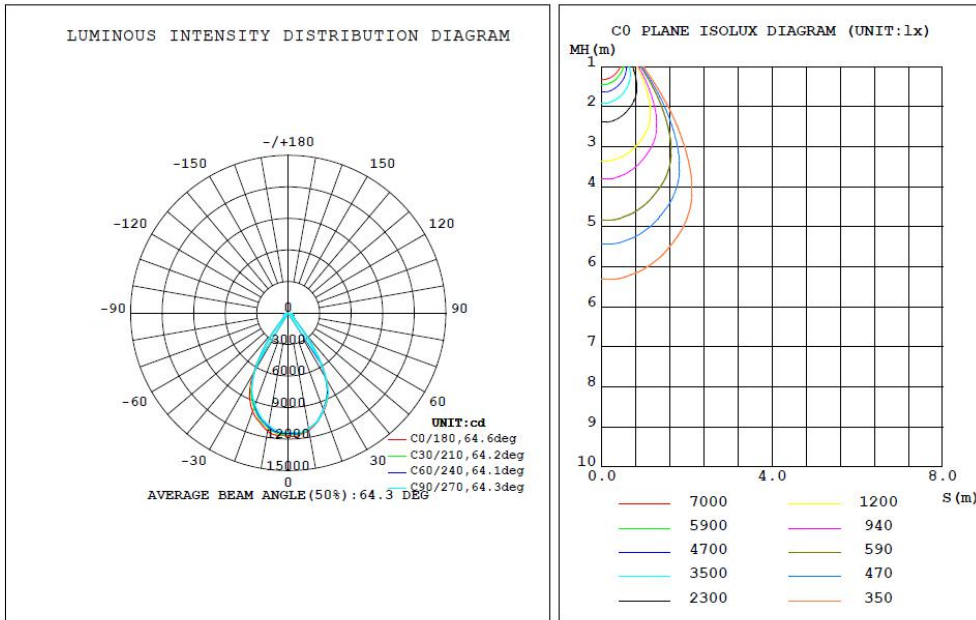

Flux out: 8586 lm

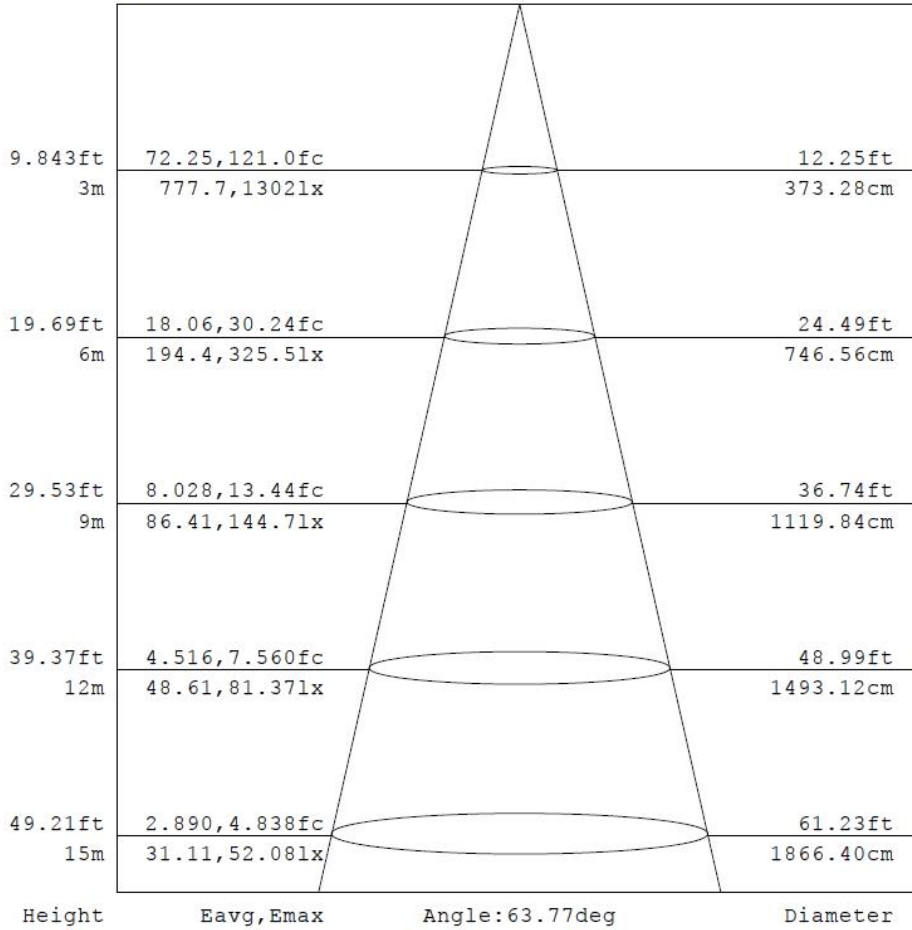

Note: The Curves indicate the illuminated area and the average illumination when the luminaire is at different distance.